

# 3/2-Way-Solenoid-Valve

## Type 02.1.01.004.02

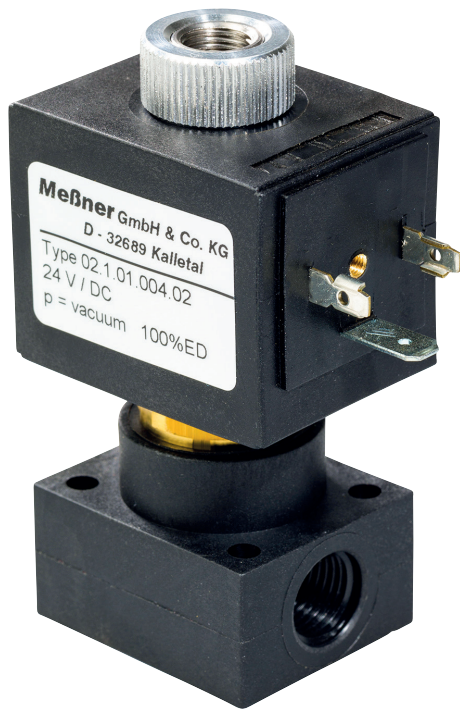

### Technical data

Type of actuation	direct control
Nominal size	4,0 mm
Pump connection P	internal thread R 1/4"
Working connection A	internal thread R 1/4"
Ventilation connection R	internal thread R 1/8"
Function	normally closed NC*
Operating pressure	max. vacuum 99,9 %
Ambient temperature	max. 80° C
Duty cycle ED	100 %
Enclosure protection in compliance with DIN 40050	IP 00 IP 65 with connector (Art.-No. 229/000003)

### Power consumption

24 V/DC	13 W
24 V/AC und 230 V/AC	13 VA

### Current consumption

24 V/DC*	0,542 A
24 V/AC	0,542 A
230 V/AC	0,059 A

### Standard voltages

24 V/DC	Art.-No. 260/004021
24 V/AC	Art.-No. 260/004022
230 V/AC	Art.-No. 260/004025

Other voltages available on inquiry

\*Function „normally open“ NO P=R

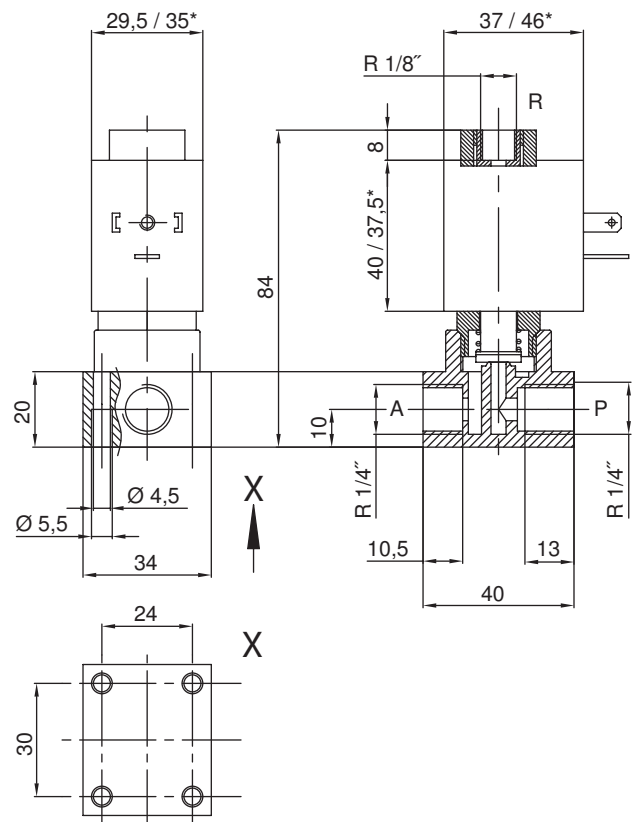

The ventilation connection R can be fitted with a sintered bronze silencer R 1/8" (Art.-No. 215/000011) as ventilation filter.

For the normally open (NO) function the ventilation connection R can be fitted with a hose nozzle R 1/8".